

**STATE OF ALASKA DEPARTMENT OF NATURAL RESOURCES
DIVISION OF MINING, LAND AND WATER**

Northern Region
3700 Airport Way
Fairbanks, AK 99709
(907) 451-2740

Southcentral Region
550 W 7th Ave., Suite 900C
Anchorage, AK 99501-3577
(907) 269-8552

Southeast Region
400 Willoughby
P.O. Box 111020
Juneau, AK 99811-1020
(907) 465-3400

**APPLICATION FOR EASEMENT
AS 38.05.850**

Non-refundable application fee: \$100*

ADL # 108224
(to be filled in by state)

Applicant's Name Edna Bay Community Doing business as: _____

Mailing Address P.O. Box EDB E-Mail: president@ednabayalaska.net

City/State/Zip EDNA BAY, ALASKA 99950

Message Phone 907 594-6107 Work Phone 907 594-6312

Is applicant a nonprofit cooperative association? yes [] no. If yes, are you applying for an exemption under AS 38.05.850(b)? yes [] no. If yes, please submit proof of nonprofit status (e.g. by-laws, articles of incorporation, tax statement).

Location of activity/Legal Description: Municipality Edna Bay Meridian Copper River
Township 68, Range 76, Section 23, NW 1/4, NW 1/4
Township _____, Range _____, Section _____, _____ 1/4, _____ 1/4

(attach extra sheets as needed)

Total length of applied-for easement (feet): 600 Total width of applied-for easement (feet): 4'
Acres encompassed by easement: .055 (43,560 square feet = 1 acre)

Specific purpose of easement (e.g. electric utility, fiber-optic conduit or cable, telecommunications tower, road, bridge, airstrip/airport, driveway, trail, drainage), and type of anticipated traffic (e.g. plane, truck, heavy equipment): Explain _____
Buried fuel transfer line and beach reader.

Are you applying for the Division of Mining, Land and Water to reserve a Public Easement? Yes No Are you applying to be granted a Private Easement? Yes No . (Note: Annual rental fee required for private easement)

*See 11 AAC 05.010 regarding fees for federal, state, and local government agencies

RECEIVED
 REGIONAL OFFICE
 2013 APR -3 AM 10:33
 DEPT. OF NATURAL RESOURCES
 DIV. OF MINING, LAND & WATER

State briefly the standards and methods of construction: e.g. regulated standards, winter trail, dirt trail, gravel road, paved road, etc.; clearing by hand, clearing/construction by mechanical equipment (state type of equipment to be used, e.g. J.D. 350, 944 F.E. loader, hydro-axe, D-8), or establishment by use only. Easement alongside existing road. Construction Methods to include clearing and construction using excavator and dumptruck.

Is this an existing use? Yes No . If yes, provide documentation verifying existing use, such as easement atlas, affidavits attesting to use and existence, pictures, etc.

Construction to begin: Fall 2013 or Spring 2014
Construction to be completed by: Fall 2014

Other permits or authorizations applied for in conjunction with this proposed project: None

If this authorization is granted, I agree to construct and maintain the improvements authorized in a workmanlike manner, and to keep the area in a neat and sanitary condition; to comply with all the laws, rules, and regulations pertaining thereto; and provided further that upon termination of the easement for which application is being made, I agree to remove or relocate the improvements and restore the area without cost to the state and to the satisfaction of the Director of the Division of Mining, Land and Water.

Heather Richter - President Edna Baylorn March 29, 2013
Applicant's Signature Date

INSTRUCTIONS: Attach a USGS map (scale of 1:63,360) or a state status plat showing the location of the proposed easement, and an environmental risk assessment questionnaire (form 102-4008A).

The final granting of a private easement or reservation of a public easement will be contingent upon our receipt of a plat depicting the post-construction location of the improvements. If your application is approved, instructions for the completion of the plat will be provided to you, or can be picked up at any of our offices.

AS 38.05.035(a) authorizes the director to decide what information is needed to process an application for the sale or use of state land and resources. This information is made a part of the state public land records and becomes public information under AS 40.25.110 and 40.25.120 (unless the information qualifies for confidentiality under AS 38.05.035(a)(9) and confidentiality is requested). Public information is open to inspection by you or any member of the public. A person who is the subject of the information may challenge its accuracy or completeness under AS 44.99.310, by giving a written description of the challenged information, the changes needed to correct it, and a name and address where the person can be reached. False statements made in an application for a benefit are punishable under AS 11.56.210.

RECEIVED
REGIONAL OFFICE
2013 APR -3 AM 10:33
DEPT. OF NATURAL RESOURCES
OF MINING, LAND & WATER

**STATE OF ALASKA DEPARTMENT OF NATURAL RESOURCES
DIVISION OF MINING, LAND AND WATER**

Contract Administration
550 W 7th Ave., Suite 640
Anchorage, AK 99501-3576
(907) 269-8594

Northern Region
3700 Airport Way
Fairbanks, AK 99709
(907) 461-2740

Southcentral Region
550 W 7th Ave., Suite 900C
Anchorage, AK 99501-3577
(907) 269-8562

Southeast Region
400 Willoughby,
Suite #400
P.O. Box 111020
Juneau, AK 99801
(907) 465-3400

APPLICANT ENVIRONMENTAL RISK QUESTIONNAIRE

The purpose of this questionnaire is to help clarify the types of activities you propose to undertake. The questions are meant to help identify the level of environmental risk that may be associated with the proposed activity. The Division of Mining, Land and Water's evaluation of environmental risk for the proposed activity does not imply that the parcel or the proposed activity is an environmental risk from the presence or use of hazardous substances.

Through this analysis, you may become aware of environmental risks that you did not know about. If so, you may want to consult with an environmental engineer or an attorney.

Edna Bay Community

Applicant's Name Edna Bay Community Doing Business As _____

Address P.O. Box EDB, Edna Bay, Alaska 99950

907,594-6312 (907,594-6301) 35c.miner@gmail.com Heather Richter

Message Phone Work Phone E-Mail Contact Person

Alt. contact Myla Poelstra

Describe the proposed activity:

Install a header and approximately 300' of buried fuel lines to transfer fuel from a delivery barge to a bulk fuel facility.

In the course of your proposed activity will you generate, use, store, transport, dispose of, or otherwise come in contact with toxic and/or hazardous materials, and/or hydrocarbons? Yes No

If yes, please list the substances and the associated quantities. Use a separate sheet of paper, if necessary.

Yes, petroleum products will be utilized in the equipment during the construction process. Also, approximately two or three times annually fuel will travel through the installed lines from the header to the bulk facility during delivery from the fuel barge.

If the proposed activities involve any storage tanks, either above or below ground, address the following questions for each tank. Please use a separate sheet of paper, if necessary, and, where appropriate, include maps or plats:

a. Where will the tank be located? N/A

b. What will be stored in the tank? N/A

c. What will be the tank's size in gallons? N/A

d. What will the tank be used for? (Commercial or residential purposes?) N/A

e. Will the tank be tested for leaks? N/A

f. Will the tank be equipped with leak detection devices? Yes No . If yes, describe: N/A

Do you know or have any reason to suspect that the site may have been previously contaminated? Yes No

If yes, please explain: _____

I certify that due diligence has been exercised and proper inquiries made in completing this questionnaire, and that the foregoing is true and correct to the best of my knowledge.

Heather Richtler - Edna Bay Community President
Applicant

9/27/13
Date

AS 38.05.035(a) authorizes the director to decide what information is needed to process an application for the sale or use of state land and resources. This information is made a part of the state public land records and becomes public information under AS 40.25.110 and 40.25.120 (unless the information qualifies for confidentiality under AS 38.05.035(a)(9) and confidentiality is requested). Public information is open to inspection by you or any member of the public. A person who is the subject of the information may challenge its accuracy or completeness under AS 44.99.310, by giving a written description of the challenged information, the changes needed to correct it, and a name and address where the person can be reached. False statements made in an application for a benefit are punishable under AS 11.56.210.

Narrative Portion
of the
Edna Bay Development Plan

This project is located within Land Estate Section 23, Township 68S, Range 76E of Copper River Meridian Alaska. I think the only way to provide a detailed legal description will have to be after the survey since it is a portion of an existing right of way located in Section 23.

The terrain is relatively flat covered mostly with small second growth spruce, hemlock, cedar and berry bushes.

There are no buildings or other structures located within the proposed area.

There is no power sources located within the proposed area.

There is no waste or waste sources located within the proposed area.

There are no hazardous substances located within the proposed area other than the petroleum products that will be used in the machines to construct the supply lines and several times per year when petroleum products travel through the transfer lines during the process of a fuel delivery.

There is no water supply or waste water to be disposed of.

There is a small area (dirt base, no concrete, approx. 40' wide) used for public parking that the buried fuel lines will be buried under from one side to the other.

The number of people using the site will be a maximum of 3 Edna Bay Bulk Fuel Facility employees. It is yet unknown the ratio of supervisor/staff. No clients will be using the site.

The buried fuel lines will be maintained by Edna Bay Bulk Fuel Facility employees on a maintenance schedule to be determined in the development plan by the AEA. No subcontractors will be utilized.

In the effect the this permit was revoked or expired, the pipeline would be removed and the ground would be shoveled and raked back to its original state as much as possible and any bare ground planted with a natural grass mix.

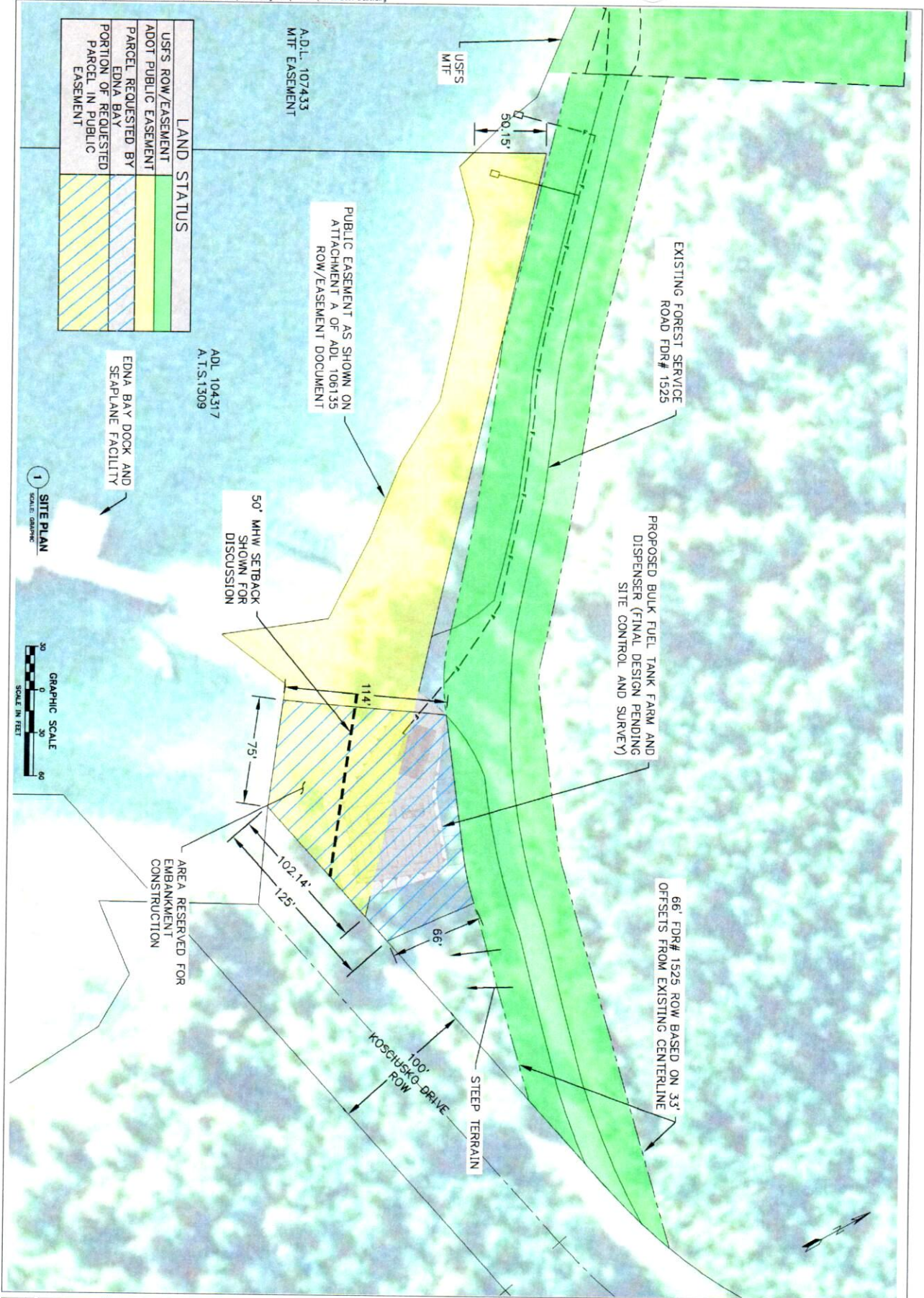

| LAND STATUS | |
|--|----------------------|
| USFS ROW/EASEMENT | [Green Box] |
| ADOT PUBLIC EASEMENT | [Light Green Box] |
| PARCEL REQUESTED BY EDNA BAY | [Blue Hatched Box] |
| PORTION OF REQUESTED PARCEL IN PUBLIC EASEMENT | [Yellow Hatched Box] |

1 SITE PLAN
SCALE: GRAPHIC

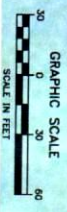

| NO. | REVISION | BY | DATE |
|-----|----------|----|------|
| | | | |
| | | | |
| | | | |
| | | | |
| | | | |

EDNA BAY
PRELIMINARY SITE CONTROL FIGURE
BULK FUEL UPGRADE PROJECT

CRW ENGINEERING GROUP, LLC
 3640 ARCTIC BLVD. SUITE 300
 ANCHORAGE, ALASKA 99503
 PHONE: (907) 562-2200
 FAX: (907) 561-2273



State of Alaska
 Department of Community and Economic Development
AIDEA/AEA
 Rural Energy Group
 813 West Northern Lights Blvd
 Anchorage, Alaska 99503

ABA **ALASKA**
 ENERGY AUTHORITY